

LOW DRAG TORQUE- ANTI-BACKLASH NUT

Threads
1/4 to 5/8

LIGHT DUTY - 15 to 35 LBS DESIGN LOAD
PRECISION QUALITY

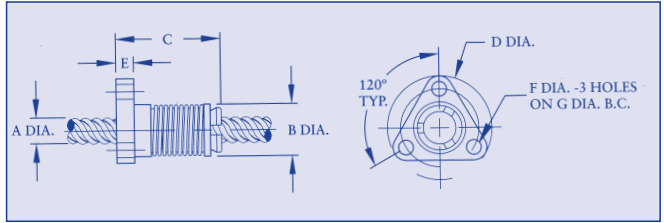
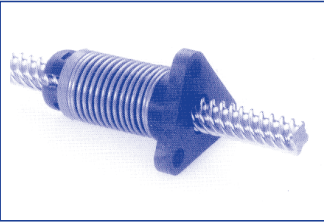

Material: Polyacetal, Engineered Plastic. Includes integrally molded flange.

Order MAS-A2 series Lead Screws (.0006 lead accuracy) separately. **ORDER BY CATALOG NUMBER**

* Efficiency for use with teflon coated Lead Screws

Catalog Number	Nominal Screw Dia.	Lead In or mm	Design Load (Dynamic)	Drag Torque	Efficiency *	Catalog Number	Nominal Screw Dia.	Lead In or mm	Design Load (Dynamic)	Drag Torque	Efficiency *
MAH-A3-1	1/4 6,35mm	0.025"	5 lbs (2 kg)	.5-2 oz-in (.003-.015NM)	21	MAH-A3-29	7/16 11,11mm	0.125"	15 lbs (7kg)	2-5 oz-in (.021-.035NM)	54
MAH-A3-2		0.050"			46	MAH-A3-30		0.250"			70
MAH-A3-3		0.062"			52	MAH-A3-31		0.500"			80
MAH-A3-4		0.200"			65	MAH-A3-32		3,0mm			52
MAH-A3-5		0.250"			79	MAH-A3-33		5,0mm			65
MAH-A3-6		0.500"			81	MAH-A3-34		6,0mm			70
MAH-A3-7		1.000"			84	MAH-A3-35		10,0mm			77
MAH-A3-8	3/8 9,35mm	1,5mm	10 lbs (5 kg)	1-3 oz-in (.007-.021NM)	51	MAH-A3-36	12,0mm	80	MAH-A3-37	0.100"	46
MAH-A3-9		2,0mm			59	MAH-A3-38	0.200"	63			
MAH-A3-10		3,0mm			68	MAH-A3-39	0.250"	67			
MAH-A3-11		0.025"			21	MAH-A3-40	0.333"	73			
MAH-A3-12		0.050"			36	MAH-A3-41	0.400"	76			
MAH-A3-13		0.083"			48	MAH-A3-42	0.500"	79			
MAH-A3-14		0.100"			53	MAH-A3-43	0.800"	83			
MAH-A3-15	0.200"	69	MAH-A3-44	1.000"	84						
MAH-A3-16	0.250"	60	MAH-A3-45	2,5mm	46						
MAH-A3-17	0.300"	76	MAH-A3-46	4,0mm	58						
MAH-A3-18	0.400"	79	MAH-A3-47	5,0mm	62						
MAH-A3-19	0.500"	81	MAH-A3-48	10,0mm	76						
MAH-A3-20	0.750"	84	MAH-A3-49	25,0mm	84						
MAH-A3-21	1.000"	84	MAH-A3-50	0.100"	40						
MAH-A3-22	1.200"	84	MAH-A3-51	0.125"	45						
MAH-A3-23	1.500"	83	MAH-A3-52	0.200"	53						
MAH-A3-24	2,0mm	47	MAH-A3-53	0.500"	76						
MAH-A3-25	4,0mm	65	MAH-A3-54	8,0mm	68						
MAH-A3-26	5,0mm	69									
MAH-A3-27	12,0mm	82									
MAH-A3-28	25,0mm	84									

Standard Mounting Dimensions

Screw Diameter A	Nut Diameter B (Max)	Nut Length C	Flange Diameter D	Flange Width E	Mounting Holes F	Bolt Circle Dia. G
1/4"	.50"	1.0"	1.00"	.18"	.143"	.750"
3/8	.70	1.9	1.50	.18	.200	1.125
7/16	.80	1.9	1.50	.18	.200	1.125
1/2	.89	2.0	1.62	.26	.200	1.250
5/8	1.06	2.0	1.75	.26	.200	1.375

Available with thread mount - Please inquire