

# LOW DRAG TORQUE- ANTI-BACKLASH NUTS

**THREADS**  
1/2,5/8,3/4

HEAVY DUTY - 150 TO 350 LBS. DESIGN LOAD  
PRECISION QUALITY

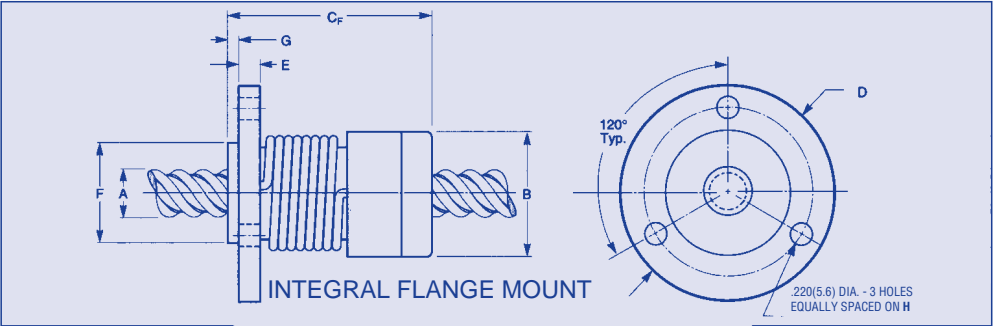

**NOTE:** 1/2 & 5/8 nuts are thread mounted. To order integral flange add **F** to end of Cat No.

3/4" nuts are only available in integral flange mount.

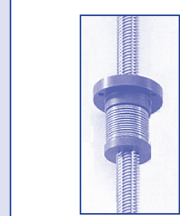
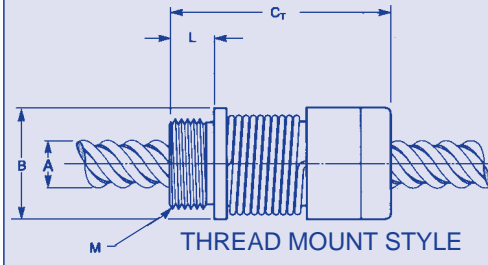

**ORDER BY CATALOG NUMBER**

Catalog Number	Nominal Screw Dia	Lead In or mm	Design Load (Dynamic)	Drag Torque	Efficiency *
MAH-A5-1	1/2" 12.70mm	0.100"	150 lbs. 68 kg	2-6 oz-in .01-.04NM	46
MAH-A5-2		0.200"			63
MAH-A5-3		0.250"			67
MAH-A5-4		0.333"			73
MAH-A5-5		0.400"			76
MAH-A5-6		0.500"			79
MAH-A5-7		0.800"			83
MAH-A5-8		1.000"			84
MAH-A5-9	2,5 mm	2,5 mm			46
MAH-A5-10		4,0 mm			58
MAH-A5-11		5,0 mm			62
MAH-A5-12		10,0 mm			76
MAH-A5-13		25,0 mm			84
MAH-A5-14	5/8" 15,88mm	0.100"	250lbs. 159 kg	2-6 oz-in .01-.04NM	41
MAH-A5-15		0.125"			47
MAH-A5-16		0.200"			59
MAH-A5-17		0.500"			77
MAH-A5-18	8,0mm				67

Catalog Number	Nominal Screw Dia.	Lead In or mm	Design Load (Dynamic)	Drag Torque	Efficiency *
MAH-A5-19	3/4" 9,05mm	0.100"	350 lbs. 159 kg	3-7 oz-in .02-.05NM	35
MAH-A5-20		0.166"			47
MAH-A5-21		0.200"			52
MAH-A5-22		0.250"			57
MAH-A5-23		0.500"			73
MAH-A5-24		1.000"			81
MAH-A5-25		1.500"			84
MAH-A5-26		2.000"			84
MAH-A5-27	2.400"	84			
MAH-A5-28	5,0mm	5,0mm			51
MAH-A5-29		10,00mm			68
MAH-A5-30		15,00mm			75
MAH-A5-31		24,00mm			81
MAH-A5-32		50,00mm			85

**Material: Polyacetal, Engineered Plastic.**  
**Including Integrally molded flange if applicable.**  
Order MAS-A2 series lead screws (.0006 lead accuracy) separately

\* Efficiency for use with teflon coated Lead Screws

## Standard Mounting Dimensions

Screw Dia.	Nut Diameter B (Max)	Nut Length CF	Nut Length CT	Flange Dia. D	Flange Width E	Pilot Dia. F	Pilot Depth G	Bolt Circle Dia. H	Thread M	Thread Length L
1/2"	1.12	2.3	2.5	1.75	.23	.93	.12	1.406	.937-16	3/8
5/8"	1.38	2.6	2.8	2.12	.30	---	---	1.75	1.25-16	1/2
3/4"	1.62	2.8	---	2.38	.31	---	---	2.00	---	---

**11M (800) 243-0986**  
In CT (203) 775-4877

**NORDEX**